

PARTS LIST

Frame with Decking Panels

Upper Leg (2 pcs)

Lower Leg (2 pcs)

Handrails (1110mm) (2 pcs)

Straight Handrail Connectors (2 pcs)

Straight Plate (2 pcs)

M10x35mm Bolt (4 pcs)

M8x16mm Bolt (6 pcs)

ASSEMBLY

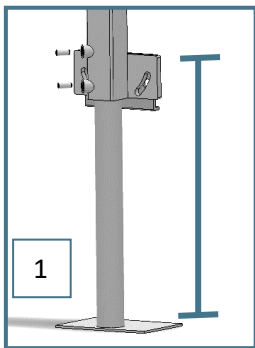

SET THE TOP OF THE BRACKET TO THE DESIRED DECKING HEIGHT.

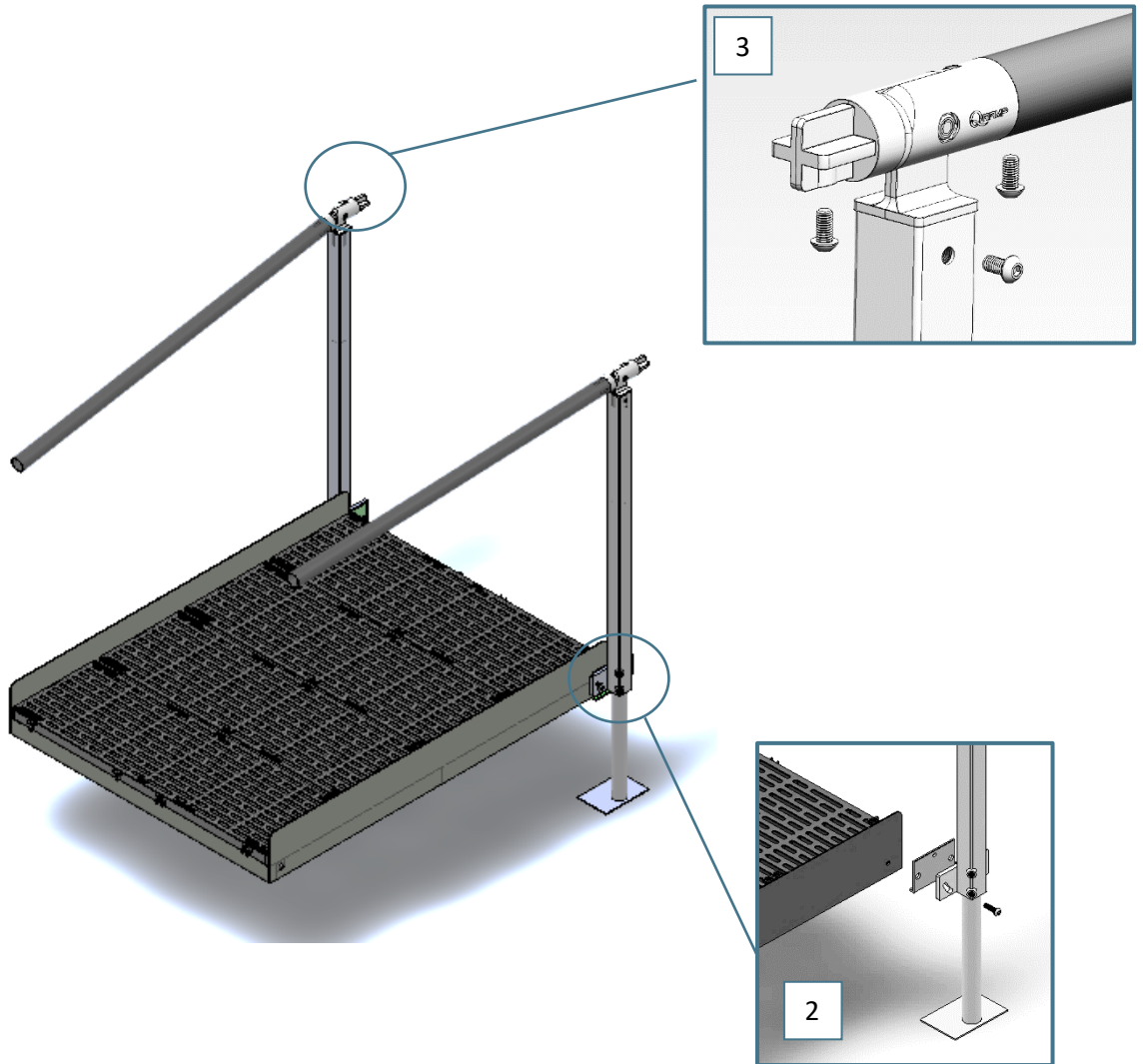

INSTRUCTIONS

- 1 – Set leg height using set screws.
- 2 – Attach leg and bracket to frame using M10x35mm bolt.
- 3 – Attach handrail connector to leg, and then attach handrail to connector using M8x16mm bolts.
- 4 – Attach Mod 1 frame to brackets of adjoining module using M10x35mm bolts.
- 5 – Attach Mod 1 handrails to adjoining module’s handrail connectors using M8x16mm bolts.

Note – after ramp has been configured, tighten all bolts.

PARTS LIST

Frame with Decking Panels

Handrails (1110mm) (2 pcs)

M10x35mm Bolt (4 pcs)

ASSEMBLY

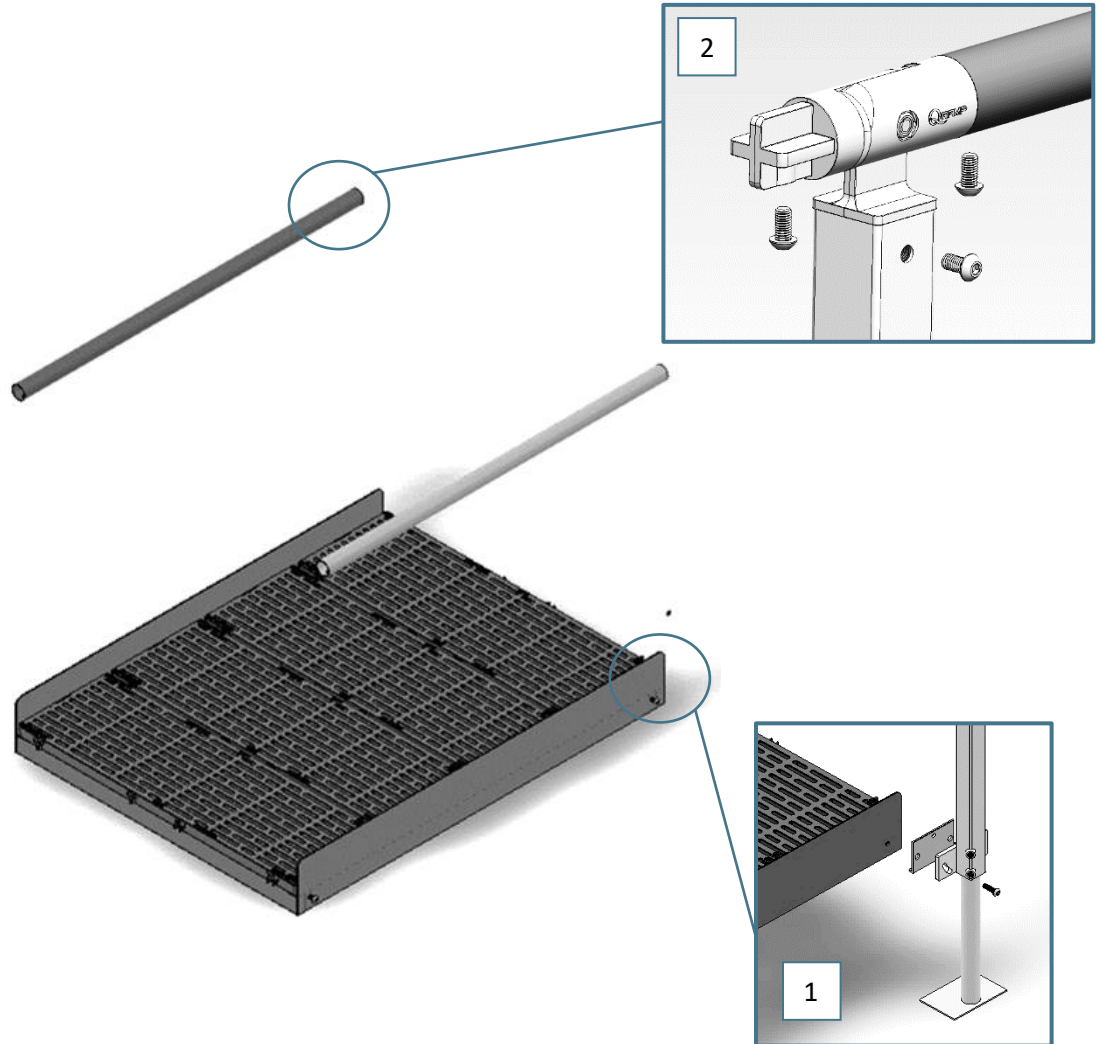

INSTRUCTIONS

- 1 – Attach Mod 2 frame to leg and bracket of connecting module using M10x35mm bolt.
- 2 – Attach Mod 2 handrails to connecting module's handrail connectors using M8x16mm bolts.

Note – after ramp has been configured, tighten all bolts.

PARTS LIST

Frame with Decking Panels
 Upper Leg Straight (2 pcs)
 Upper Leg Corner (2 pcs)
 Lower Leg (4 pcs)
 Support Leg Left (1 pc)
 Support Leg Right (1 pc)
 Platform Plate Left (2 pcs)

Platform Plate Right (2 pcs)
 Straight Plate (2 pcs)
 Handrail – 1190mm (1 pc) A
 Handrail – 1130mm (1 pc) B
 Handrail – 351mm (1 pc) C
 Handrail – 295mm (1 pc) D

Straight Handrail Connectors (2 pcs)
 Corner Handrail Connector Right (3 pcs)
 Corner Handrail Connector Left (1 pc)
 M10x45mm Bolt (4 pcs)
 M10x35mm Bolt (6 pcs)
 M8x16mm Bolt (18 pcs)

ASSEMBLY

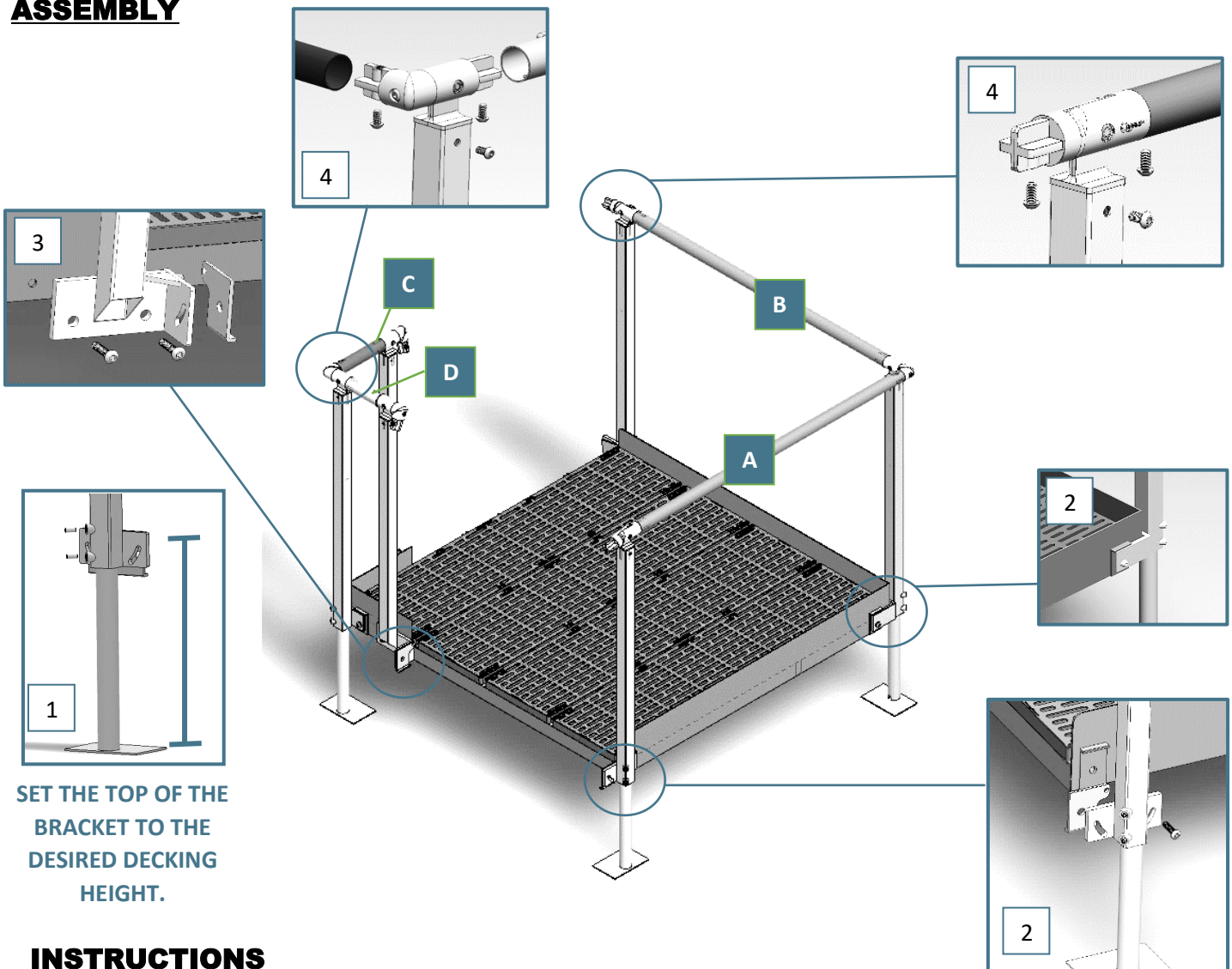

SET THE TOP OF THE BRACKET TO THE DESIRED DECKING HEIGHT.

INSTRUCTIONS

- 1 – Set desired leg height of all four legs using set screws.
- 2 – Attach legs to frame using M10x35mm bolts.
- 3 – Attach support legs to frame using M10x45mm bolts.
- 4 – Attach handrail connectors to legs, and then attach handrails to connectors using M8x16mm bolts.

Note – after ramp has been configured, tighten all bolts.

PARTS LIST

Frame with Decking Panels
Upper Leg (2 pcs)
Lower Leg (2 pcs)

Curved Handrails (2 pcs)
Straight Handrail Connectors (2 pcs)
Straight Plate (2 pcs)

M10x35mm Bolt (2 pcs)
M8x16mm Bolt (6 pcs)
M8x60mm Bolt (4 pcs)
M8 Lock Nuts (4 pcs)

ASSEMBLY

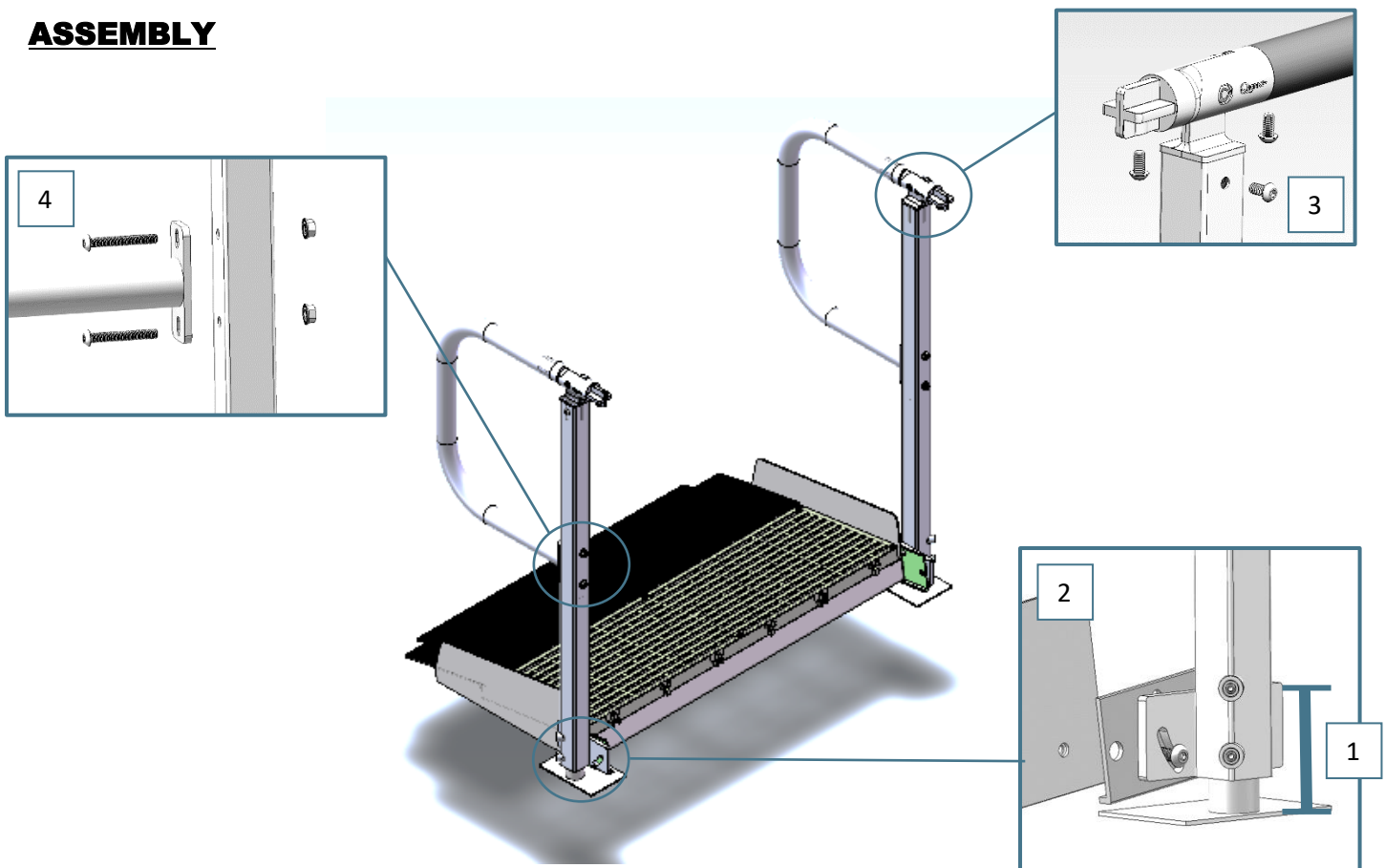

INSTRUCTIONS

- 1 – Set leg height at 3.5” using set screws.
- 2 – Attach leg and bracket to frame using M10x35mm bolt.
- 3 – Attach handrail connector to leg, and then attach handrail to connector, both using M8x16mm bolts.
- 4 – Attach handrail bracket to the leg using M8x60mm bolts and nuts.

Note – after ramp has been configured, tighten all bolts.

PARTS LIST

Frame with Decking Panels
Upper Leg (2 pcs)
Lower Leg (2 pcs)
Support Leg (2 pcs)

Curved Handrails (2 pcs)
Straight Handrails (2 pcs)
Straight Handrail Connectors (4 pcs)
Straight Plate (2 pcs)

M10x35mm Bolt (6 pcs)
M8x16mm Bolt (12 pcs)
M8x60mm Bolt (4 pcs)
M8 Lock Nut (4 pcs)

ASSEMBLY

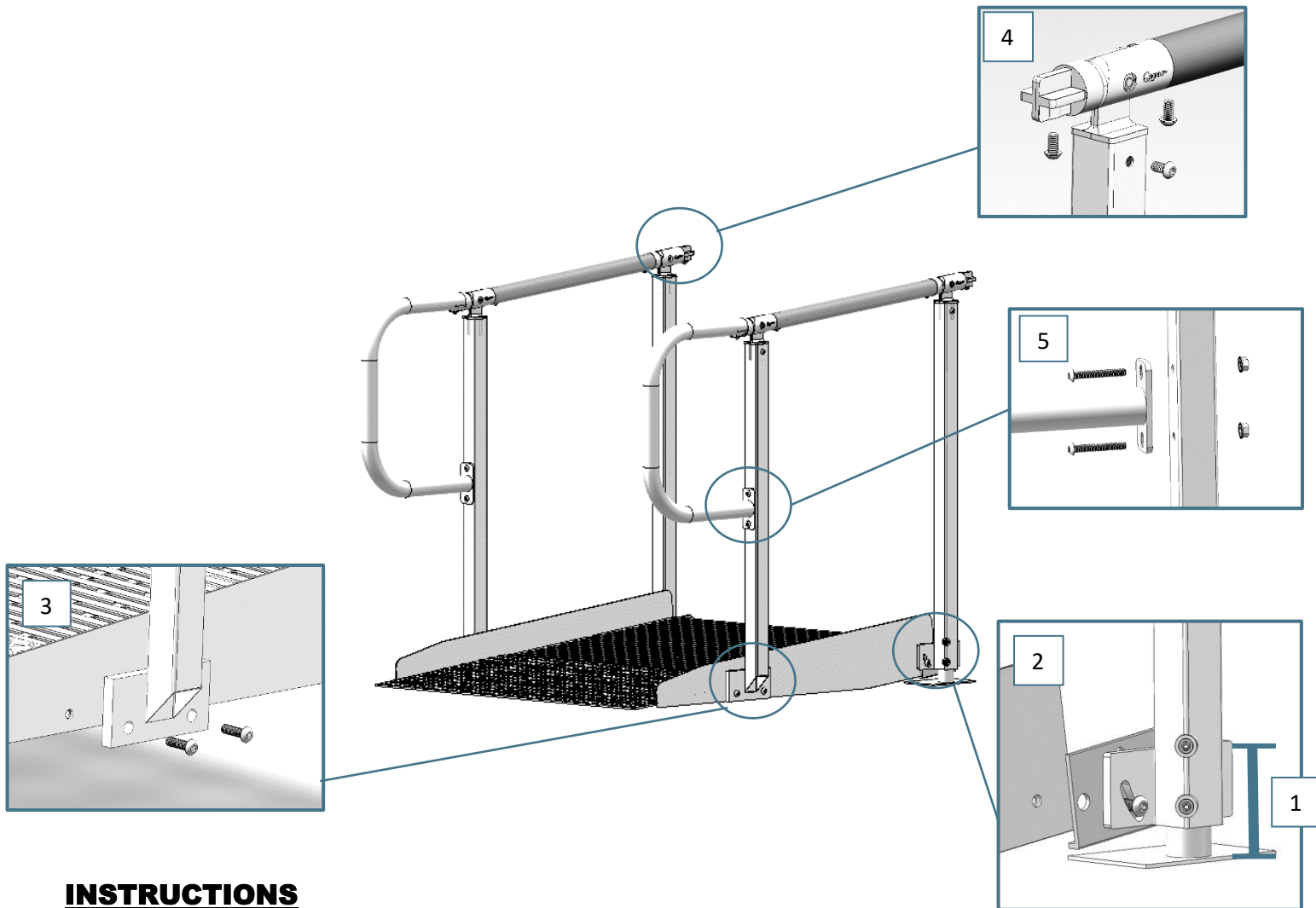

INSTRUCTIONS

- 1 – Set leg height at 3.5–4 inches using set screws.
- 2 – Attach leg and bracket to frame using M10x35mm bolt.
- 3 – Attach support leg to frame using M10x35mm bolts.
- 4 – Attach handrail connector to leg, and then attach curved and straight handrails to connector using M8x16mm bolts.
- 5 – Attach handrail bracket to the leg using M8x60mm bolts and nuts.

Note – after ramp has been configured, tighten all bolts.

PARTS LIST

Frame

M8 Flared Nut (2 pcs)

Washer (2 pcs)

M8x50mm Carriage Bolt (2 pcs)

ASSEMBLY

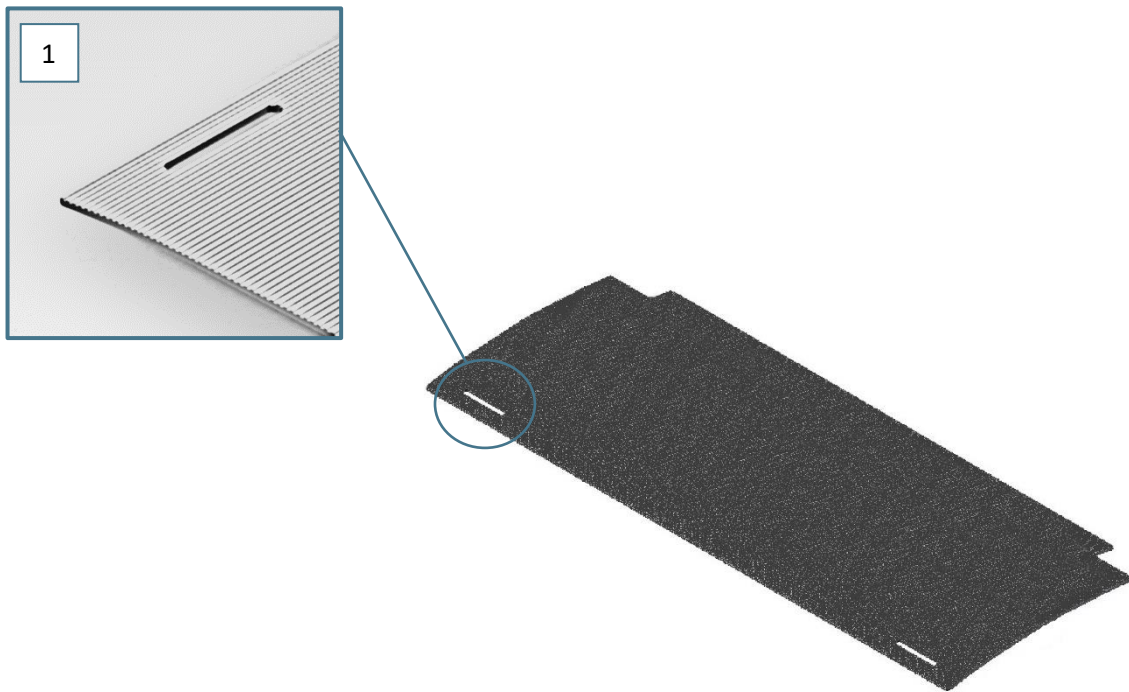

INSTRUCTIONS

- 1 – Slot for carriage bolt.
- 2 – Bolt Mod 6 to decking panel to the connecting module.

Note – after ramp has been configured, tighten all bolts.

PARTS LIST

Frame with Decking Panels

Handrails (201mm) (2 pcs)

M10x35mm Bolt (4 pcs)

ASSEMBLY

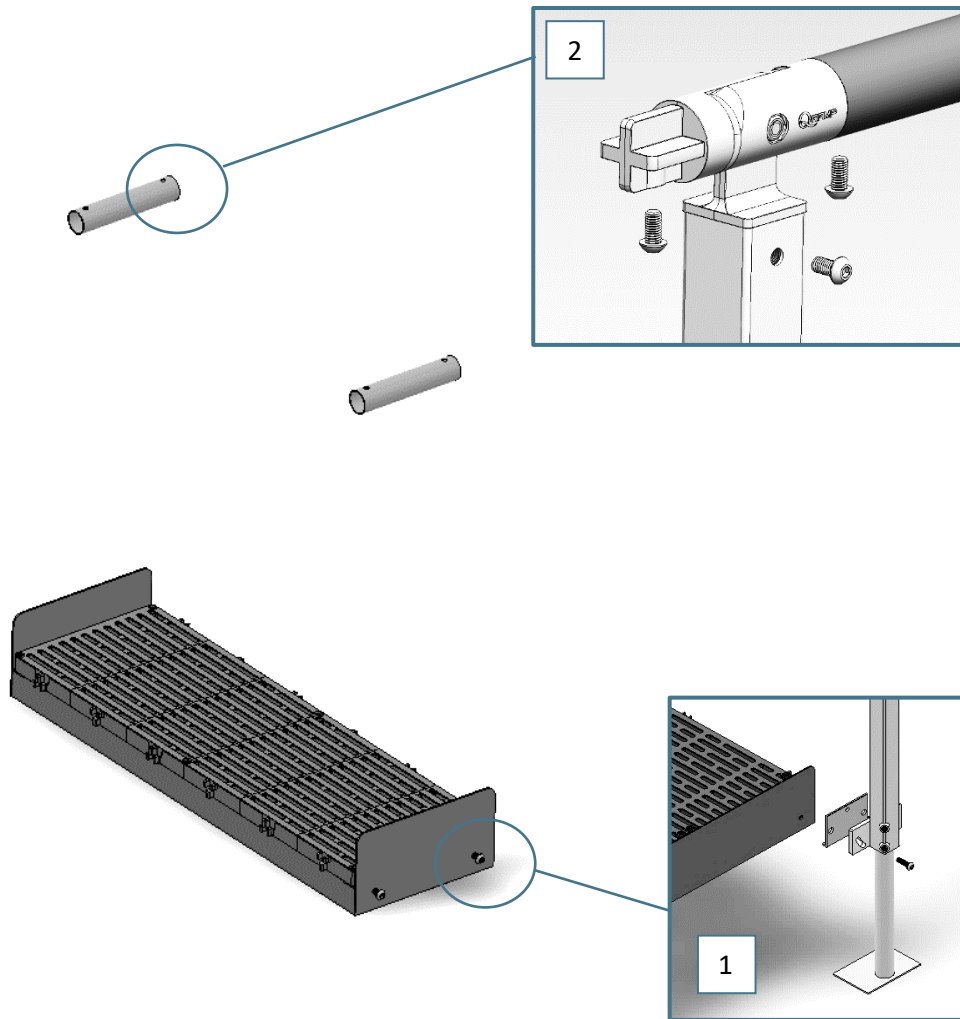

INSTRUCTIONS

- 1 – Attach Mod 7 frame to leg and bracket of adjoining module using M10x35mm bolt.
- 2 – Attach Mod 7 handrails to adjoining module's handrail connectors using M8x16mm bolts.

Note – after ramp has been configured, tighten all bolts.

PARTS LIST

Frame with Decking Panels
Upper Leg (2 pcs)
Lower Leg (2 pcs)

Handrails (201mm) (2 pcs)
Straight Handrail Connectors (2 pcs)
Straight Plate (2 pcs)

M10x35mm Bolt (4 pcs)
M8x16mm Bolt (6 pcs)

ASSEMBLY

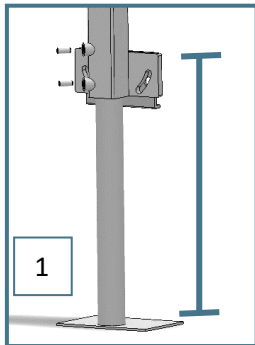

SET THE TOP OF THE
BRACKET TO THE DESIRED
DECKING HEIGHT.

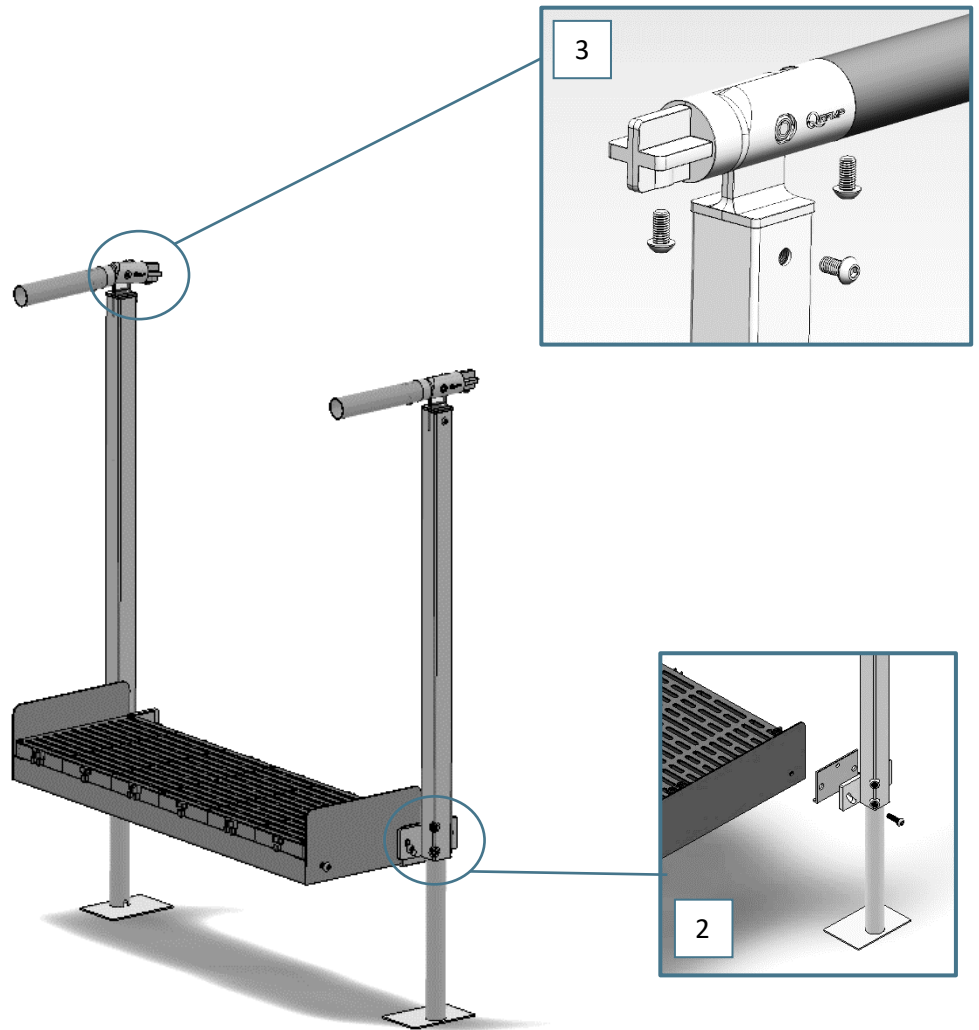

INSTRUCTIONS

- 1 – Set leg height using set screws.
- 2 – Attach leg and bracket to frame using M10x35mm bolt.
- 3 – Attach handrail connector to leg, and then attach handrail to connector using M8x16mm bolts.
- 4 – Attach Mod 7B frame to brackets of adjoining module using M10x35mm bolts.
- 5 – Attach Mod 7B handrails to adjoining module's handrail connectors using M8x16mm bolts.

Note – after ramp has been configured, tighten all bolts.

PARTS LIST

Frame with Decking Panels	Platform Plate Left (2 pcs)	Handrail – 1494mm (1 pc) A
Upper Leg Straight (2 pcs)	Platform Plate Right (2 pcs)	Handrail – 1434mm (1 pc) B
Upper Leg Corner (2 pcs)	Straight Plate (2 pcs)	Handrail – 502mm (1 pc) C
Lower Leg (4 pcs)	Straight Handrail Connectors (2 pcs)	Handrail – 442mm (1 pc) D
Support Leg Left (1 pc)	Corner Handrail Connector Right (3 pcs)	M10x45mm Bolt (4 pcs)
Support Leg Right (1 pc)	Corner Handrail Connector Left (1 pc)	M10x35mm Bolt (6 pcs)
		M8x16mm Bolt (18 pcs)

ASSEMBLY

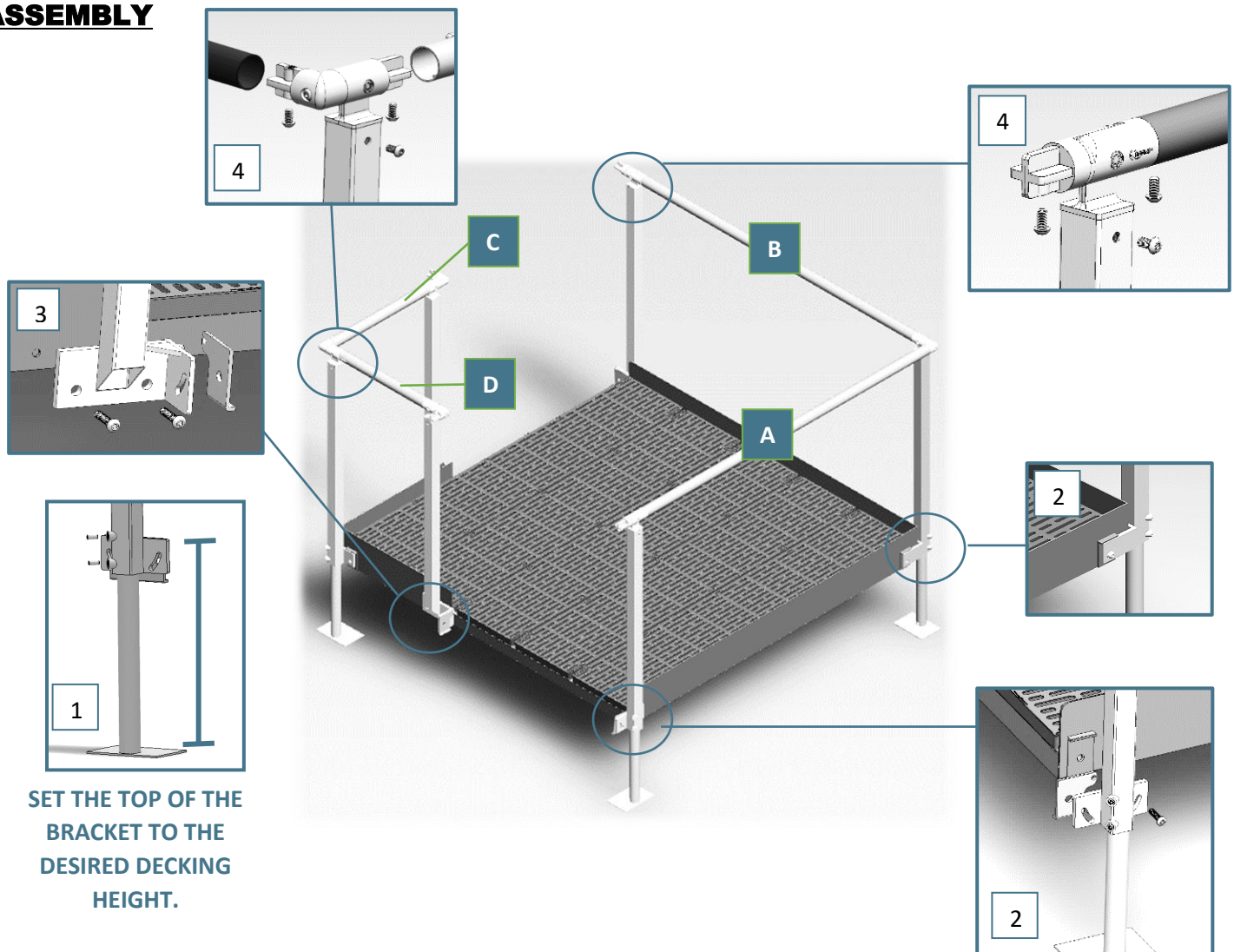

SET THE TOP OF THE BRACKET TO THE DESIRED DECKING HEIGHT.

INSTRUCTIONS

- 1 – Set desired leg height of all four legs using set screws.
- 2 – Attach legs to frame using M10x35mm bolts.
- 3 – Attach support legs to frame using M10x45mm bolts.
- 4 – Attach handrail connectors to legs, and then attach handrails to connectors using M8x16mm bolts.

Note – after ramp has been configured, tighten all bolts.

PARTS LIST

Frame with Decking Panels
 Upper Leg Straight (2 pcs)
 Upper Leg Corner (1 pc) E
 Upper Leg Corner (1 pc) F
 Lower Leg (4 pcs)
 Support Leg Left (1 pc)
 Support Leg Right (1 pc)

Platform Plate Left (2 pcs)
 Platform Plate Right (2 pcs)
 Straight Plate (2 pcs)
 Straight Handrail Connectors (2 pcs)
 Corner Handrail Connector Right (2 pcs)
 Corner Handrail Connector Left (2 pcs)

Handrail – 1249mm (1 pc) A
 Handrail – 1130mm (1 pc) B
 Handrail – 295mm (2 pcs) C
 M10x45mm Bolt (4 pcs)
 M10x35mm Bolt (6 pcs)
 M8x16mm Bolt (18 pcs)

ASSEMBLY

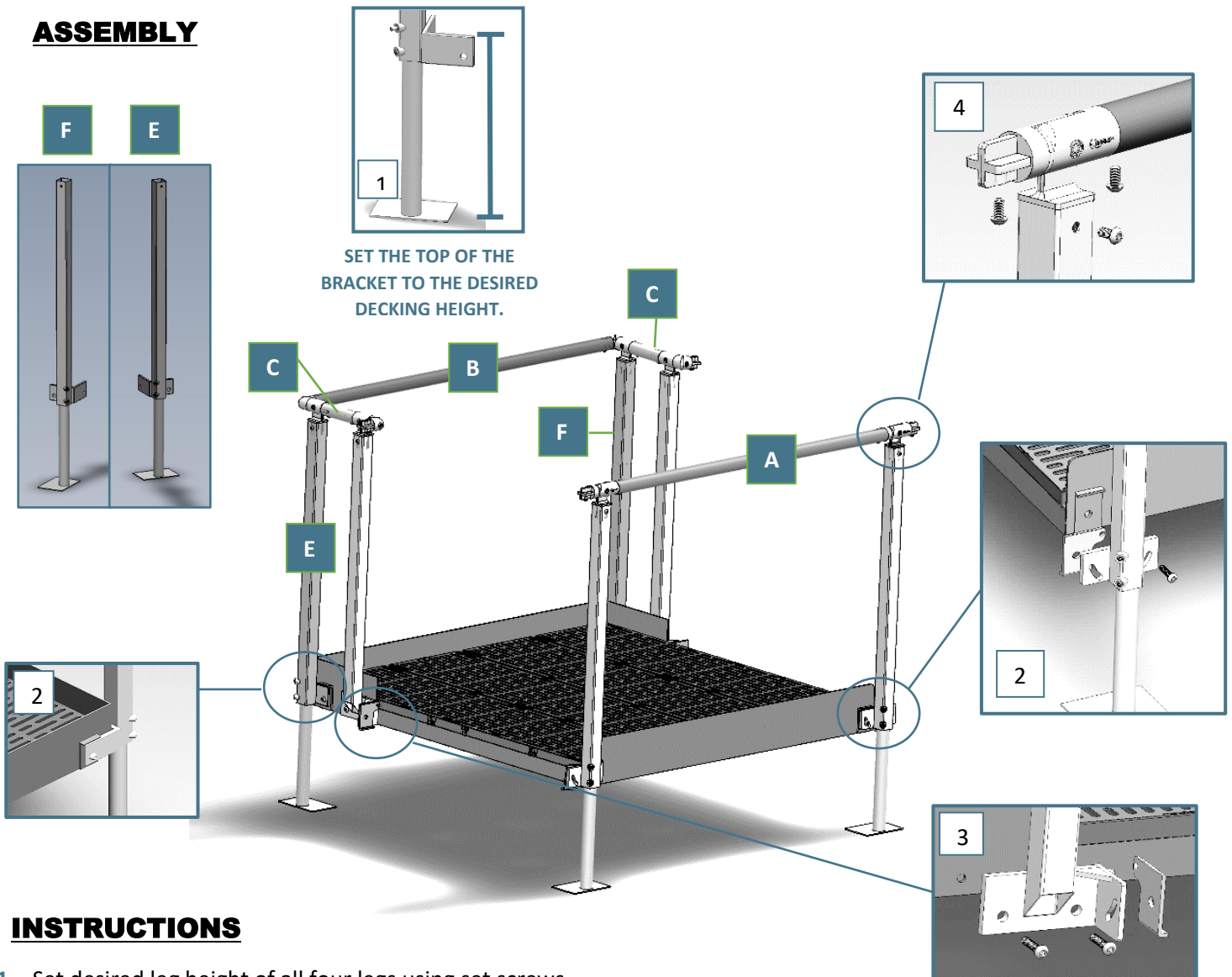

SET THE TOP OF THE BRACKET TO THE DESIRED DECKING HEIGHT.

INSTRUCTIONS

- 1 – Set desired leg height of all four legs using set screws.
- 2 – Attach legs to frame using M10x35mm bolts.
- 3 – Attach support leg to frame using M10x45mm bolts.
- 4 – Attach handrail connectors to legs, and then attach handrails to connectors using M8x16mm bolts.

Note – after ramp has been configured, tighten all bolts.

PARTS LIST

Frame with Decking Panels
 Upper Leg Straight (2 pcs)
 Upper Leg Corner (1 pc) E
 Upper Leg Corner (1 pc) F
 Lower Leg (4 pcs)
 Support Leg Left (1 pc)
 Support Leg Right (1 pc)

Platform Plate Left (2 pcs)
 Platform Plate Right (2 pcs)
 Straight Plate (2 pcs)
 Straight Handrail Connectors (2 pcs)
 Corner Handrail Connector Right (2 pcs)
 Corner Handrail Connector Left (2 pcs)
 Corner Handrail Connector Left (2 pcs)

Handrail – 1554mm (1 pc) A
 Handrail – 1434mm (1 pc) B
 Handrail – 442mm (2 pcs) C
 M10x45mm Bolt (4 pcs)
 M10x35mm Bolt (6 pcs)
 M8x16mm Bolt (18 pcs)

ASSEMBLY

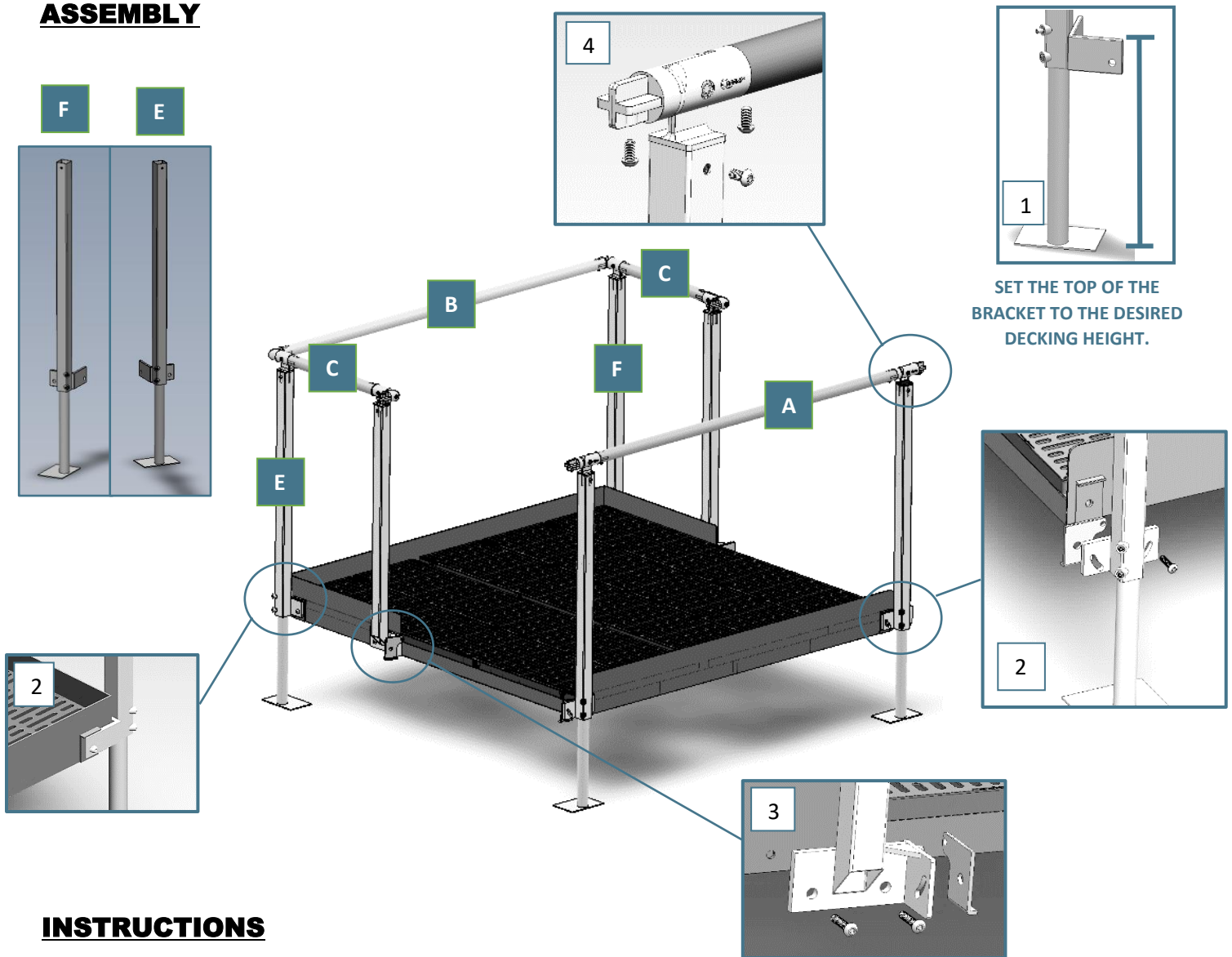

INSTRUCTIONS

- 1 – Set desired leg height of all four legs using set screws.
- 2 – Attach legs to frame using M10x35mm bolts.
- 3 – Attach support leg to frame using M10x45mm bolts.
- 4 – Attach handrail connectors to legs, and then attach handrails to connectors using M8x16mm bolts.

Note – after ramp has been configured, tighten all bolts.

PARTS LIST

Mod 1/2 Guardrail (4 pcs)

Vertical Spindles (22 pcs)

Spindle Plastic Cap (44 pcs)

#10 Washers (6 pcs)

Self Drilling Screws (6 pcs)

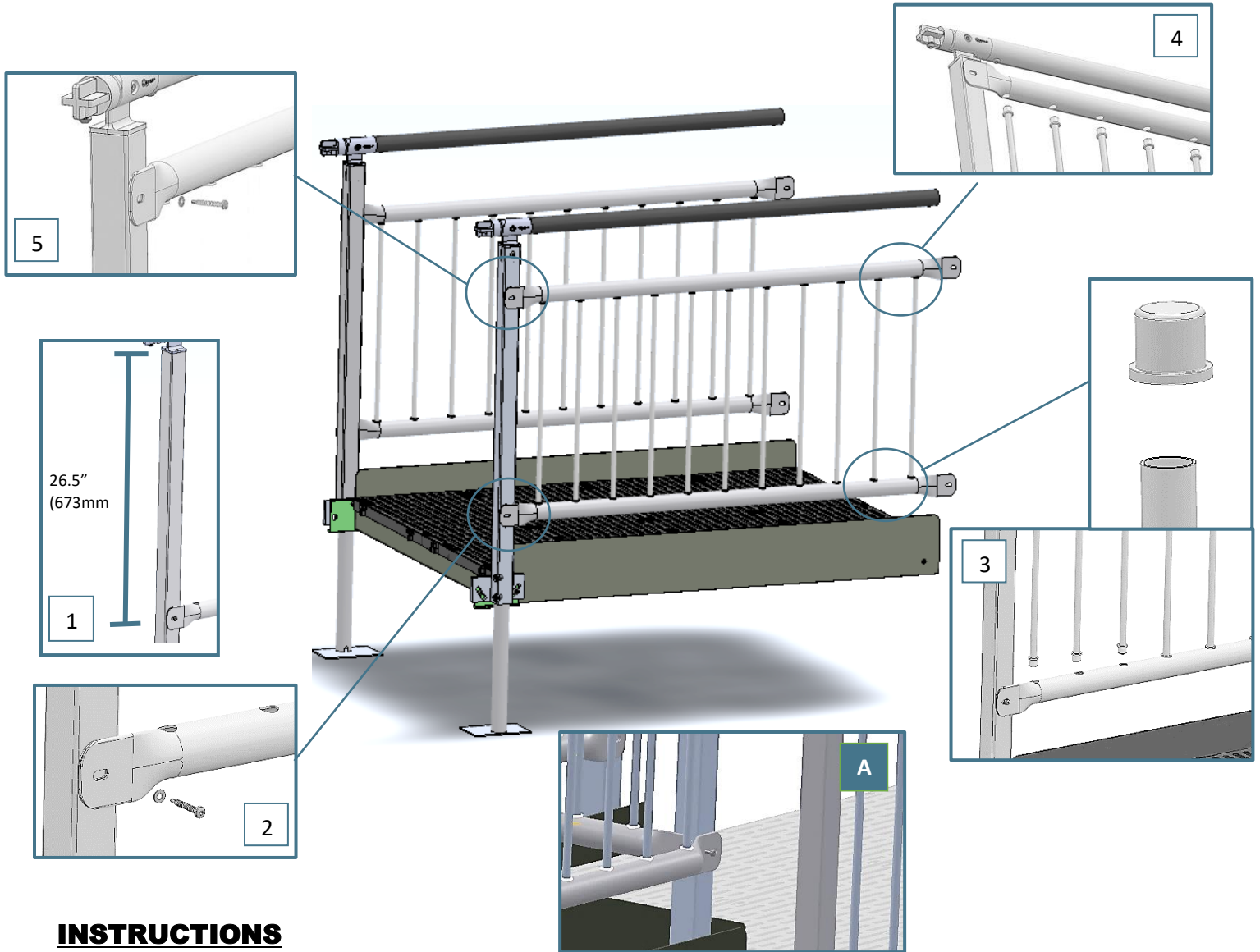

INSTRUCTIONS

- 1 – Measure 26.5" (673mm) down from the top of the upper leg (or 9.5" up from bottom of the upper leg) and mark in the middle of the leg where the guardrail will attach – make sure the guardrail is in line with the module's sidewall – see diagram A for when attaching to a platform
- 2 – Secure the lower guardrail using self drilling screws and washers provided
- 3 – Install plastic cap onto both ends of the spindles and place into lower guardrail holes
- 4 – Install upper guardrail onto the spindles – you may have to use a rubber mallet for this step
- 5 – Secure the upper guardrail to leg using self drilling screws and washers

PARTS LIST

Mod 8.1 Guardrail (2 pcs)
 Mod 8.2 Guardrail (2 pcs)
 Mod 8.3 Guardrail (2 pcs)

Mod 8.4 Guardrail (2 pcs)
 Vertical Spindles (36 pcs)
 Spindle Plastic Cap (72 pcs)

Self Drilling Screws (16 pcs)
 #10 Washers (16 pcs)



INSTRUCTIONS

- 1 – Measure 26.5" (673mm) down from the top of the upper leg (or 9.5" up from bottom of the upper leg) and mark in the middle of the leg where the guardrail will attach – make sure the guardrail is in line with the module's sidewall – see diagram A for when attaching to a Mod 1
- 2 – Secure the lower guardrail using self drilling screws and washers provided
- 3 – Install plastic cap onto both ends of the spindles and place into lower guardrail holes
- 4 – Install upper guardrail onto the spindles – you may have to use a rubber mallet for this step
- 5 – Secure the upper guardrail to leg using self drilling screws and washers

PARTS LIST

Mod 10.1 Guardrail (2 pcs)
 Mod 10.2 Guardrail (2 pcs)
 Mod 8.4 Guardrail (4 pcs)

Vertical Spindles (37 pcs)
 Spindle Plastic Cap (74 pcs)

Self Drilling Screws (16 pcs)
 #10 Washers (16 pcs)

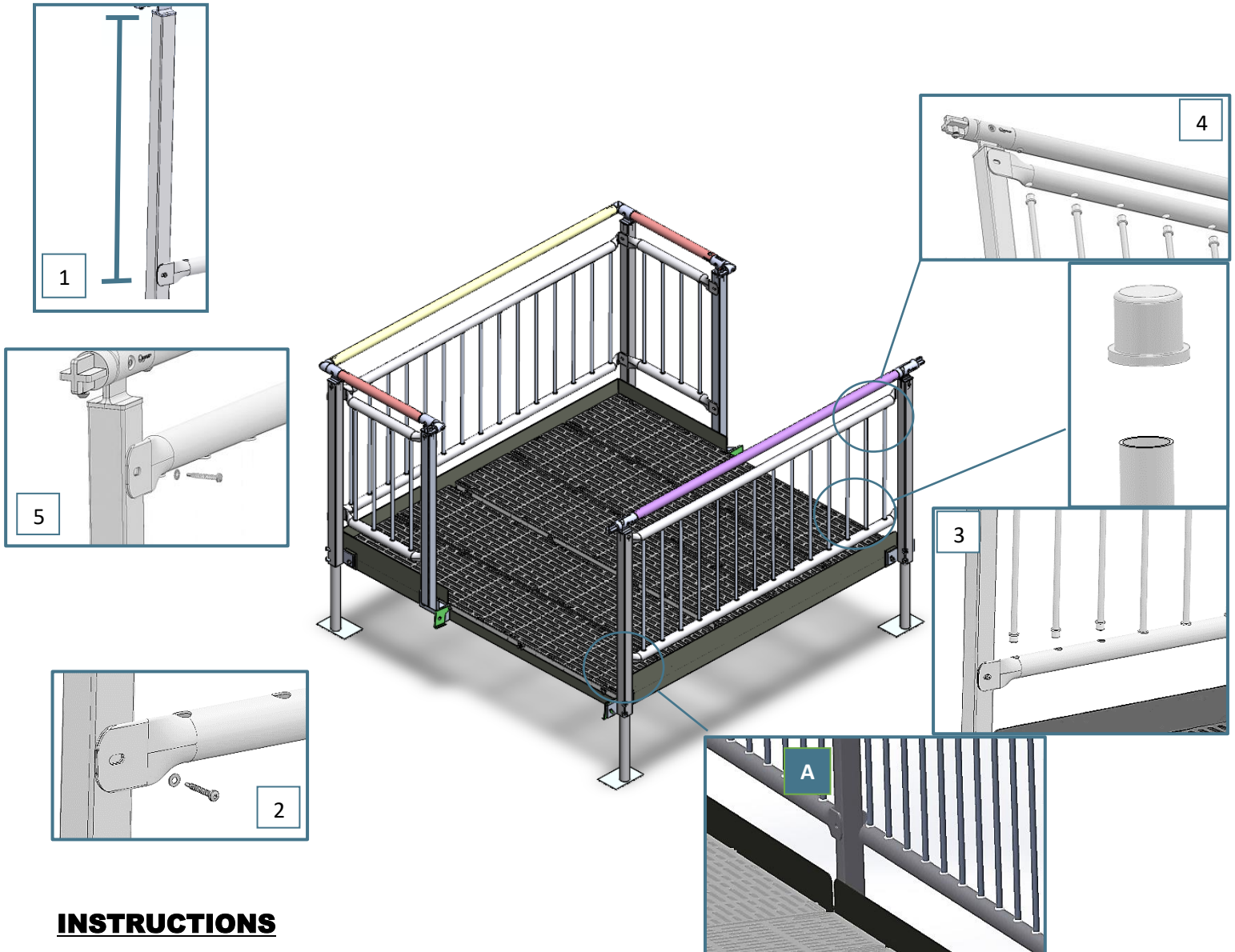

INSTRUCTIONS

- 1 – Measure 26.5" (673mm) down from the top of the upper leg (or 9.5" up from bottom of the upper leg) and mark in the middle of the leg where the guardrail will attach – make sure the guardrail is in line with the module's sidewall – see diagram A for when attaching to a Mod 1
- 2 – Secure the lower guardrail using self drilling screws and washers provided
- 3 – Install plastic cap onto both ends of the spindles and place into lower guardrail holes
- 4 – Install upper guardrail onto the spindles – you may have to use a rubber mallet for this step
- 5 – Secure the upper guardrail to leg using self drilling screws and washers

